

LET YOUR
dreams
TAKE
Flight



RESIDENTIAL PLOTS @ GAUR YAMUNA CITY

WHY YEIDA?

MAKE A STUNNING

ARRIVAL



At NCR's most iconic destination

YEIDA stands for Yamuna Expressway Industrial Development Authority and today has the largest industrial land bank in the country which would see rapid development. The initial budget set for YEIDA was Rs. 12,500 crore approximately. With an area of 2,689 sq km under its belt, it is the biggest industrial township project that covers connectivity, industrial development, and infrastructure development. YEIDA also promises to develop smart villages along the 165 km stretch. It is one of the driving forces behind Noida's growth and development. YEIDA's master plan of 2031 predicts rapid and extensive real estate development. Yamuna Expressway is a development that connects Delhi/Noida/Gr. Noida with Western UP/Agra and Lucknow.

- World-class 165 km Yamuna Expressway
- India's longest 6-lane controlled-access expressway
- Installed with 'Intelligent Transport System
- The faster connection between National Capital Region to Agra and Lucknow
- The fastest growing Economic Zone
- Home to the fast developing Noida International Airport
- Mega Industrial projects are being commissioned in the region ensuring economic upliftment
- 1000 acres Film City announced
- Another Gurgaon Story getting unfolded
- Super connectivity with approved Metro and Proposed Mono Rail
- Zip drive to Noida & Gr. Noida in 15-20 mins
- The only F1 circuit in the country
- Multiple Industrial hubs being developed such as Textile Zone, Electronic Zone & Toy City
- YEIDA Region is currently the economic hotspot of the country

GET READY TO

BOARD



THE THRIVING IT HUB

- A large number of IT & ITES companies
- Various big companies are opening up
- Growing job opportunities



MODERN INFRASTRUCTURE

- Wider roads with huge scope for expansion
- Modern shopping malls & commercial spaces
- World-class hospitals, schools, colleges & other educational institutes



PROGRESSIVE GOVERNMENT INITIATIVES

- Investment-friendly infrastructure
- Industrial parks, entertainment zones and SEZs being developed



FAVOURITE AMONGST BIG INVESTORS

- Aatm-Nirbhar Bharat - Homegrown Tech giant Intex is also looking for a big-time investment in Greater Noida.
- Already made a deal of 650 crores right along Yamuna Expressway
- Textile Park on 200 acres of land will generate 5 Lakh Jobs
- Microsoft is likely to set up new 4,000-employee campus near the upcoming Noida International Airport - the second-largest in India





WHY YAMUNA EXPRESSWAY? CHECK-IN TO THE WORLD OF OPPPORTUNITIES

Yamuna Expressway has today evolved as one of the most vibrant real estate destinations. With a number of ongoing world-class developments and meticulous expansion, it is poised to change the face of Delhi-NCR.



Disclaimer: All information above is in reference from newspapers and news portals.

MOST MODERN INFRASTRUCTURE

-  It's a 165 km long 6-lane Expressway surrounded by 1,187 VILLAGES comprising of 6 DISTRICTS
-  The travelling time between AGRA & DELHI that stretches 211 km has come down to 150 minutes & just 90 minutes from Greater Noida.
-  The U.P. government has declared Yamuna Expressway belt as an ELECTRONICS MANUFACTURING ZONE
-  The U.P. government has appointed Yamuna Expressway as the nodal agency of the project and YEIDA has already identified 5,000 HECTARES for this purpose.
-  PATANJALI'S Rs. 6,000-CRORES Herbal Food Park will generate employment for 85000
-  WORLD TRADE CENTRE is investing 21 BILLION DOLLARS spread across 42 acres
-  India's Fourth Largest IT-BPO DESTINATION
-  VIVO, Rs. 3500 CRORES a leading mobile manufacturer has taken 169 acres of land and will invest creating 25,000 JOBS
-  Dream destination for home buyers
-  Jewar is rapidly developing towards becoming the most beautiful city of the World
-  UP's first Metro Coach Manufacturing Company will generate EMPLOYMENT for 25000
-  Metro Extension till JEWAR AIRPORT TERMINAL by 2025
-  Proposed monorail & ISBT
-  F1 Track at Buddh International Circuit
-  TOY CITY will be developed on a 100 ACRE land
-  Aviation Industry & Transport Hub - 5000 Hectares
-  TEXTILE PARK on 200 acres of land will generate 5 LAKH JOBS
-  The biggest PAYTM Campus spread across 10 acres to provide 15000 employments
- Infosys, India's second largest software firm to invest Rs. 750 crores in the first phase

Disclaimer: All images including stock images, colours, pictures and accessories are indicative and used for illustrative purposes only. For the actual project details, please refer to the specifications mentioned in the subsequent pages of this brochure.



LIFETIME ASPIRATIONS... NOW SET TO SOAR HIGH TRULY WORLD CLASS

Noida International Airport is poised to be India's largest airport and among the world's largest airports. Only the O'Hare International Airport and the Dallas/Fort Worth International Airport are larger, with eight and seven runways respectively. The airport is giving a major fillip to infrastructure, employment creation, demand for residential, commercial, retail, hospitality, while changing the property market dynamics in the region.

- Proposed as a 2-runway airport by 2022-23
- Future expansion into a 7200-acre 6-runway airport
- It will handle 5 million passengers per annum (MPA) initially
- Up-to 60 MPA after its expansion over a period of 30 years



SUPERFAST CONNECTIVITY

Noida International Airport will be connected to the Yamuna Expressway, allowing domestic and international tourists to reach Delhi, Noida, Agra, Mathura and Vrindavan. The six-lane road will provide direct connectivity from the Yamuna Expressway to the site of the airport. Also to be connected to Delhi Metro via the Noida Metro route and via the Delhi-Faridabad-Ballabhgarh-Palwal-Jewar route.



MAJOR UPDATES

- January 2020: Land acquisition completed for phase-1 which required 1334 hectares out of 5000 hectares.
- Phase-1 of the airport project to be completed by year 2023.
- 7 October 2020: Final Agreement signed between NIAL (Noida International Airport Limited) and Zurich AG, the Swiss company selected to build the Noida International Airport.



TAKE OFF ON A BLOCKBUSTER JOURNEY

One-of-its-kind hub for art, entertainment & cinema INDIA'S 'BIGGEST' FILM CITY

While it will revive the region's fortunes, there will be unprecedented boost to price appreciation and increased infrastructure activity. It will see a spurt in demand for luxury residential, commercial and hospitality segments also, reviving the property market in nearby areas like Noida, Greater Noida and Yamuna Expressway.

THE BLUEPRINT

- Dedicated Infotainment Zone with all world-class civil, public & technological facilities
- Industrial area (studios, sets) will spread over 780 acres
- The remaining 220 acres for commercial purposes
- Comprising outdoor locations, open grounds, food court (s), a shopping complex (es), a theatre & a film university.
- Proposed as meticulous development of 5 zones
- Government's one-of-the-most ambitious projects
- Massive boost to investment, growth & employment





YOUR DREAM DESTINATION IS HERE! @



‘A COMPLETE CITY’

Gaur Yamuna City is an integrated township, spread over a massive 101 hectares (250 acres) of land. Thoughtfully planned as one-of-the-biggest amalgamations of residential, commercial, retail, recreation and fun, it is a self-sustained, eco-rich world, ready to offer you a lifestyle that you had been waiting for so many years.



**VILLAS, PLOTS, APARTMENTS, EDUCATION, SHOPPING,
SPORTS, RECREATION & MUCH MORE**

Disclaimer: All images including stock images, colours, pictures and accessories are indicative and used for illustrative purposes only. For the actual project details, please refer to the specifications mentioned in the subsequent pages of this brochure.

Disclaimer: All information above is in reference from newspapers and news portals.



**GAUR
YAMUNA
CITY**

**A 101 HECTARES (250 ACRES)
INTEGRATED TOWNSHIP
ON YAMUNA EXPRESSWAY**

ELEVATE YOUR LIFESTYLE TO A NEW HIGH

DESTINATION NEXT

Gaur Yamuna City (GYC) is an integrated township sprawled over a massive 101 hectares (250 acres). It is situated on the Yamuna Expressway, which is a 6 lane (extendable to 8 lanes), 165 km. long access-controlled highway connecting GYC to Noida, Greater Noida and Delhi. A well-planned highway with flyovers and interjections enabling clutter-free traffic. Proposed metro will further enhance its connectivity.

Gaur Yamuna City offers Plots, Apartments, Retail Shops, Studio Apartments, Themed Villas, Sports and a lot more.



108 Feet Lord Krishna Statue and Shri Radha Krishna Temple (Under Construction)

Artist's Impression

HIGHLIGHTS

- Approx. 36421 Sq. Mtr. (9 acres) of Yamuna Lake Park with Boating Facility.
- Possession started in group housing project - 16th Parkview and plotted development projects - 2nd & 32nd Parkview, families already moved in.
- Operational GYC Galleria Convenient Shopping Center
- India's tallest statue of Lord Krishna standing at 108 feet atop a temple (under construction).
- Operational Gaur's International School.
- 4 Km. road infrastructure in place.
- 4 Villa projects under development.
- Rain water harvesting, sewage treatment plant and solid waste management system.

Introducing
7TH PARKVIEW
Luxury By Nature



For the first time, Gaur is launching residential plots that face international standard cricket ground on one side and Lord Krishna Temple on the other side. Nestled within relaxed surroundings, it's where you will inhabit your dream world, blessed with world-class amenities and facilities.

**RESORT STYLE LIVING
AMIDST RELAXED ENVIRONS**

- Acres of natural landscapes & well-manicured gardens
- Open air environment to feel rejuvenated all the time
- Panoramic views of nature & plush greems for the lifetime

Disclaimer: All images including stock images, colours, pictures and accessories are indicative and used for illustrative purposes only. For the actual project details, please refer to the specifications mentioned in the subsequent pages of this brochure.

INTRODUCING



At

7TH PARKVIEW

LUXURY BY NATURE

WELCOME TO A FIRST-CLASS LIVING EXPERIENCE

Elegant Residential Plots in close vicinity to
Upcoming Noida International Airport



Set close to the world-class Noida International Airport, Aero Villas is a dream abode designed exclusively for the luxury seekers. Synonymous with absolute comfort and exquisite finesse, it is your very own sanctuary of luxury and peace in the heart of NCR's most happening destination, Yamuna Expressway.

Be part of a safe and uplifting environment in this gated enclave filled with modern amenities, offering panoramic views of the breathtaking skyline. Come; let your dreams take flight.



AEROVILLAS
RESIDENTIAL PLOTS | 7TH PARKVIEW
GAUR YAMUNA CITY

Disclaimer: All images including stock images, colours, pictures and accessories are indicative and used for illustrative purposes only. For the actual project details, please refer to the specifications mentioned in the subsequent pages of this brochure.



MASTER PLAN

1. YAMUNA DWAR
2. SANGAM DWAR
3. CAPITOL HILL GATE

- GAURS RUNWAY SUITES
- THE HUB
- PETROL PUMP
- MULTI LEVEL CAR PARKING
- COMMERCIAL FOOT PRINT

D. DISPENSARY

- NURSING HOME (NH)

GR-01. ECO PARK

- LAKE YAMUNA PARK
- CHILDREN PARK
- PICNIC SPOT
- BOATING FACILITIES
- FOOD COURT
- LAKE PROMENADE & BIRD WATCHING

**GR-02. RECREATIONAL GREEN AREA
(SPORTS PARK)**

- OPEN AIR THEATER
- CHILDREN PLAY AREA
- CRICKET GROUND

FACILITIES

- RELIGIOUS PLOT
- MILK BOOTH
- CLUB FACILITIES

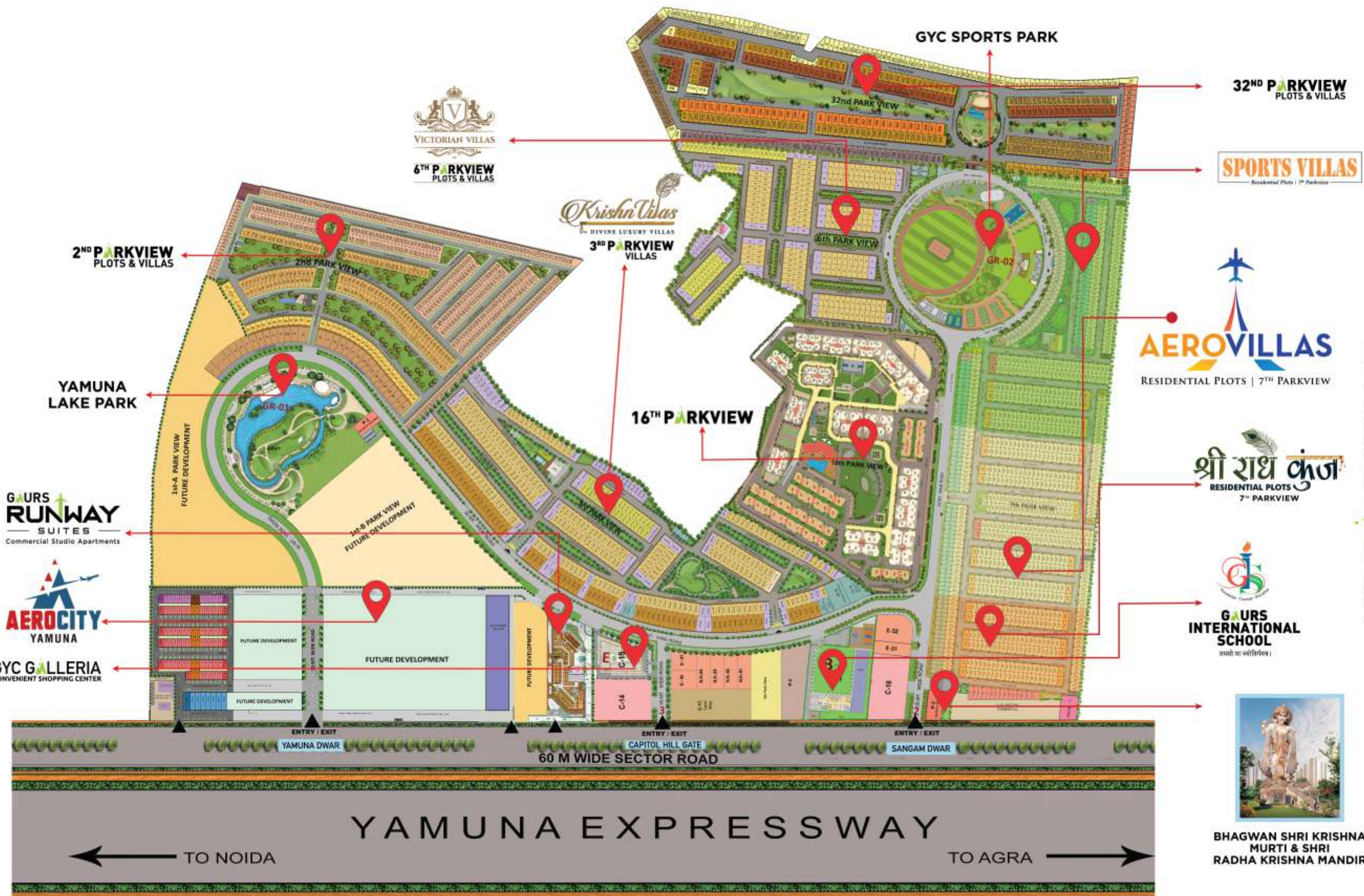

32ND PARKVIEW
PLOTS & VILLAS

SPORTS VILLAS

AEROVILLAS
RESIDENTIAL PLOTS | 7TH PARKVIEW

श्री राध कंज
RESIDENTIAL PLOTS
7TH PARKVIEW



**GAURS
INTERNATIONAL
SCHOOL**

**BHAGWAN SHRI KRISHNA
MURTI & SHRI
RADHA KRISHNA MANDIR**

7TH PARKVIEW
Luxury By Nature



88.20 sqmt. (105 sqyd.)	324
98.00 sqmt. (117 sqyd.)	1
103.95 sqmt. (124 sqyd.)	36
111.16 sqmt. (133 sqyd.)	2
120.68 sqmt. (144 sqyd.)	16
123.20 sqmt. (147 sqyd.)	1
143.50 sqmt. (172 sqyd.)	2

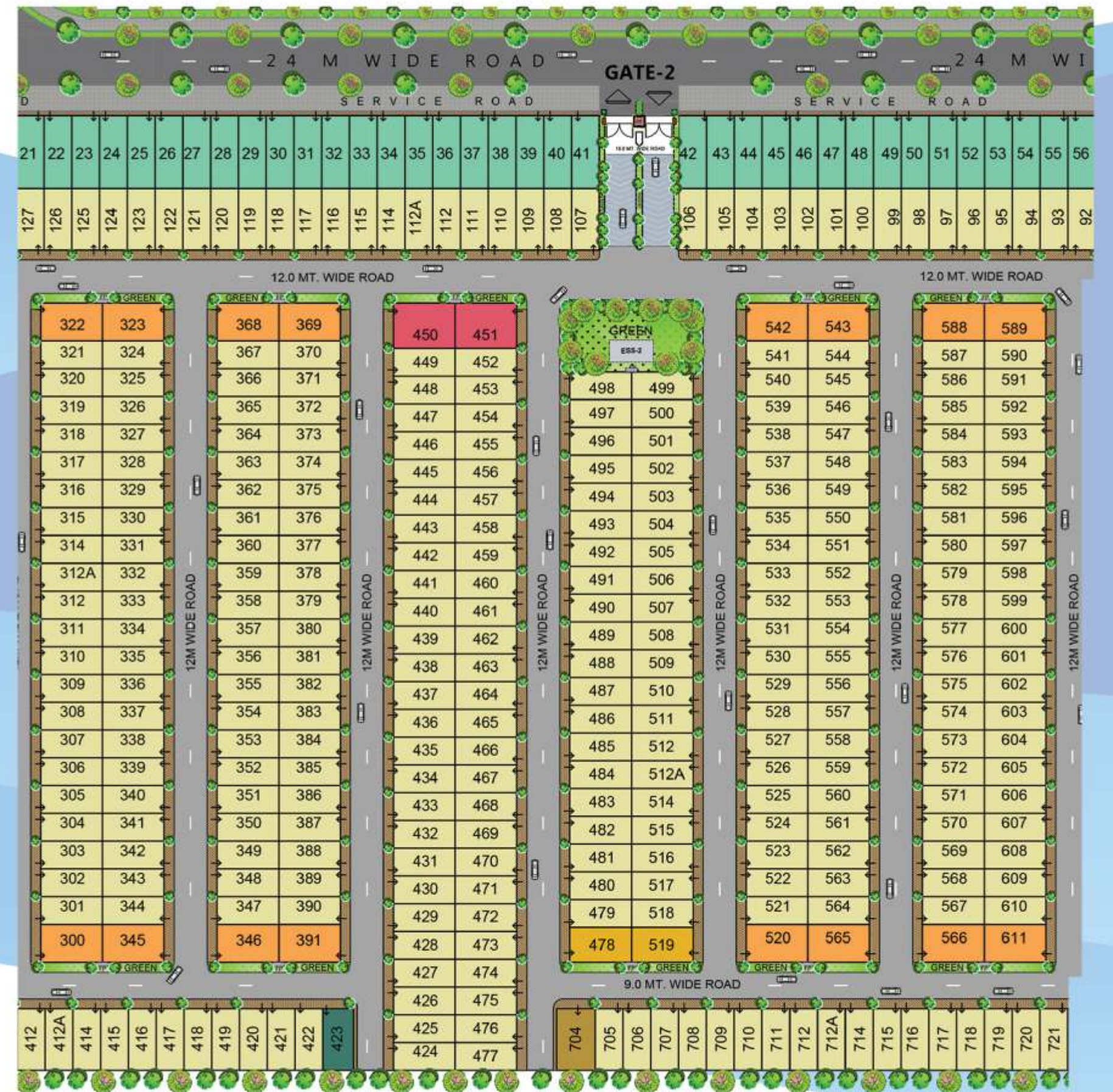

Only indicative and not a legal opinion. All project related sanctions can be seen in person at our office. 134, mto-10764-93 ft. 134re-0424-93 mto (approx).



Artist's Impression



THE ULTIMATE LOUNGE FOR LIVING

Aero Villas are premium plots that are a part of 7th Parkview - a plotted development project in Gaur Yamuna City. These plots can be developed into beautiful living abodes. This project will have an International standard cricket ground on one side and the majestic 108 feet Lord Krishna Murti on the other side. Living here would definitely elevate your lifestyle to the skies.



THE PERFECT AERO BRIDGE FOR HEALTH & SPORTS LOVERS

Walkable distance to a plethora of sports facilities
Developing International Standard Cricket Ground, Tennis, Badminton, Volleyball,
Basketball, Skating Rink, Athletic Track & more.

- Exclusive Yoga Park • Kids' Play area • Jogging track
- Open Gym • Beautiful Lake / Water Body



REJUVENATE YOUR SENSES

The Club at 7th Parkview will be an absolute heaven for the health and fitness enthusiasts with all the latest amenities. While looking for some amusement on free evenings you can choose from various indoor and outdoor game options at our state-of-the-art clubhouse.

- *Gymnasium • Swimming Pool • Table Tennis • Pool Table • Chess*
- *Carrom • Foosball • Party Area • Multi-purpose Hall*



SUGGESTIVE UNIT PLAN

PLOT AREA:
88.2 SQ. MTR.
(105 SQ. YD.)

Plot Area - 88.2 sq.mtr. (105 sq. yd.)
Total Covered Area of the plot
74.22 + 73.22 + 48.12 = 195.56 sq. mtr.
(798.50) + (788.00) + (517.50) = (2104.00 sq. ft.)

GROUND FLOOR PLAN

Carpet Area	- 53.90 sq. mtr. (580.00 sq. ft.)
External Wall Area	- 5.69 sq. mtr. (61.20 sq. ft.)
COVD. Verandah	- 14.63 sq. mtr. (157.30 sq. ft.)
Total Area	- 74.22 sq. mtr. (798.50 sq. ft.)
Open Area	- 13.98 sq. mtr. (150.40 sq. ft.)

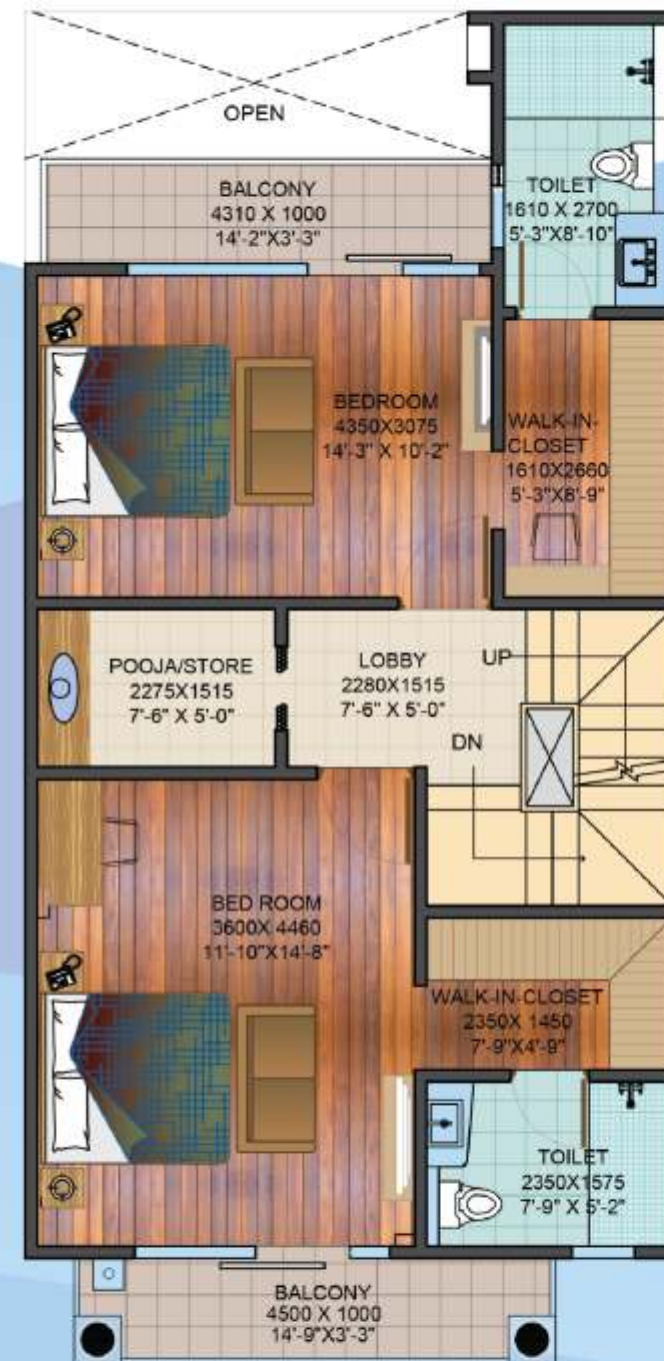

FIRST FLOOR PLAN

Carpet Area	- 60.15 sq. mtr. (647.40 sq. ft.)
External Wall Area	- 4.17 sq. mtr. (44.80 sq. ft.)
Balcony Area	- 8.90 sq. mtr. (95.80 sq. ft.)
Total Area	- 73.22 sq. mtr. (788.00 sq. ft.)



SECOND FLOOR PLAN

Carpet Area	- 40.40 sq. mtr. (434.60 sq. ft.)
External Wall Area	- 3.42 sq. mtr. (36.70 sq. ft.)
Balcony Area	- 4.30 sq. mtr. (46.20 sq. ft.)
Total Area	- 48.12 sq. mtr. (517.50 sq. ft.)

PROJECT SPECIFICATIONS

7TH PARKVIEW

TOTAL SITE AREA	140063.40 SQM. (34.61 ACRE)
PLOTTED AREA	89750.17 SQM. (22.17 ACRE)
CLUB PLOT AREA	600 SQM. (0.14 ACRE)
GREEN AREA	10372.66 SQM. (2.56 ACRE)
ROAD AREA	39326.80 SQM. (9.71 ACRE)
ELECTRICAL FEEDER PILLER	13.77 SQM. (148.21 SQ. FT.)
TOTAL NO. OF PLOTS	954

ENTRANCE GATEWAY FOR 7TH PARK VIEW GATE:- 2

- i. 6m wide opening with M.S gate as detail and design.
- ii. Guard room on ENTRY GATE - 2 As per detail.
 - a) Flooring - Granite stone/ Tile
 - b) Internal walls - beige tiles till 2.4m from FFL
 - c) External walls - paint over plaster
 - d) Doors & windows - UPVC / Aluminium frame with glass
- iii. GRC Jaali on guard room top structure element's as detail and design.
 - a) LOGO - mounted over Jaali frame as design.
- iv. Entrance Gate [Entry part] - Granite / Sandstone / Paver Block.

GATE:- 3

- v. 6m wide opening with M.S gate as detail and design.
+1.2m wide opening with M.S. wicket gate for Pedestrian as detail & design.
- vi. Guard room + Toilet's for guard on ENTRY GATE-3 As per detail.
 - e) Flooring - Granite stone/Tile
 - f) Internal walls - beige tiles till 2.4m from FFL
 - g) External walls - paint over plaster
 - h) Doors & windows - Upvc / Aluminium frame with glass
- vii. GRC Jaali on guard room top structure element's as detail and design.
 - a) LOGO - mounted over Jaali frame as design.
- viii. Entrance Gate [Entry part] - Granite / Sandstone / Paver Block.

GATE:- 4

- ix. 7.5m wide opening with M.S gate as detail and design.
+1.2m wide opening with M.S. wicket gate for Pedestrian as detail & design.
- x. Guard room on ENTRY GATE-4 As per detail.
 - i) Flooring - Granite stone/Tile
 - j) Internal walls - beige tiles till 2.4m from FFL
 - k) External walls - paint over plaster
 - l) Doors & windows - Upvc / Aluminium frame with glass
- xi. GRC Jaali on guard room top structure element's as detail and design.
 - a) LOGO - mounted over Jaali frame as design.
- xii. Entrance Gate [Entry part] - area - Granite / Sandstone / Paver Block.

Internal Roads (9m wide right of way & 12m wide right of way):-
Interlocking tile finished road with walking path & street light as per architecture layout .

GREEN AREAS:

- i. YOGA AREA- Exclusive Yoga Park with a hard paved footpath.
- ii. COMMUNITY AREA- Soft & Hard paved as per detail & design.
 - a) Kids' Play area.
 - b) Jogging track & walking track - concrete finish.
 - c) Open Gym Equipments- 4 nos.
 - d) Seesaw- 2 nos. , Merry go round- 1 nos. , parallel bars- 1 nos.
 - e) Seating - 4nos. bench
 - f) Water Body & landscape features
 - g) Entry gate- 3 nos.

CLUB [LAND AREA-600 SQM.]:-

- i. **Multipurpose Hall (Ground floor)**
 - a) Covered Area - 125.4 Sq. mt. (1350 sq. ft. approx)
 - b) Flooring - Vitrified Tiles
 - c) Ceiling - POP finished with paint
 - d) Walls - Paint over Plaster
 - e) Male & female toilet .
- ii. **Indoor play area (on First floor)**
 - a) Area - 125.4 Sq. mt. (1350 Sq. ft. approx)
 - b) Flooring - Vitrified Tiles
 - c) Ceiling - POP finished with paint
 - d) Walls - Paint over Plaster
 - e) Table tennis table - 2 Nos.
 - f) Pool Table - 1 No.
 - g) Chess carrom board - 2 Nos.
 - h) Foosball table - 1 No.
- iii. **Gymnasium & swimming pool with open deck (Second floor)**
 - i) Area - 83.61 Sq. mt. (900 Sq. ft. approx:- Gym + open deck area)
 - j) Flooring - Vitrified Tiles
 - k) Ceiling - POP finished with paint
 - l) Walls - Paint over Plaster
 - m) Equipments - Treadmill - 1 No., Bikes - 1 No., Benches - 1 No., Dumble with rack - 2 set.
 - n) Changing Room - Male & Female with shower & w.c. in each with locker.
- iv. **Swimming Pool (main)**
 - a) Pool Size - 14.6m x 3.6m (with independent standalone filter system)
 - b) Pool depth - 1.1m (max.)
 - c) Finishes - Tiles
 - d) Pool deck area - finished with tile flooring
- v. **Under ground water tank [400 KLD]+& pump room [In Club basement].**
- vi. **Club Green**
 - a) Open Party area outside Hall - Natural grass / Shurbs / Plants
 - b) Lighting - Street Light poles
 - Parking - Paved (As sanction drawing.)
- vii. **Staircase - stone flooring as selection & railing as design.**

ESS/CSS & METER ROOM

- i. Meter room for 7th PARK VIEW.
- ii. ESS/CSS as marked in drawing / capacity as per detail.
- iii. Feeder Pillars Provided In Green strips enclosed by green.
- iv. DG sets only for common area street lights & external common services.

PROJECTS @ GAUR YAMUNA CITY

ONGOING



ACTUAL IMAGE



3RD PARKVIEW
PLOTS & VILLAS
RERA NO: UPRERAPRJ16103



ARTIST'S IMPRESSION



RERA NO: UPRERAPRJ351477



ARTIST'S IMPRESSION



RERA NO: UPRERAPRJ16087



ARTIST'S IMPRESSION



RERA NO: UPRERAPRJ16087



ACTUAL IMAGE



6TH PARKVIEW
PLOTS & VILLAS
RERA NO: UPRERAPRJ15838



ARTIST'S IMPRESSION



RERA NO: UPRERAPRJ351477



ARTIST'S IMPRESSION



RERA NO: UPRERAPRJ16087



ARTIST'S IMPRESSION



COMMERCIAL PLOTS
RERA NO: UPRERAPRJ42117

DELIVERED



ACTUAL IMAGE

2ND PARKVIEW
RESIDENTIAL PLOTS (VILLAS)
DELIVERED
RERA NO: UPRERAPRJ44664



ACTUAL IMAGE

32ND PARKVIEW
RESIDENTIAL PLOTS (VILLAS)
DELIVERED
RERA NO: UPRERAPRJ4193



ACTUAL IMAGE

16TH PARKVIEW
2/3/4 BHK APARTMENTS
& INDEPENDENT FLOOR
PHASE-I DELIVERED
RERA NO: UPRERAPRJ6801



ACTUAL IMAGE

GYC GALLERIA
CONVENIENT SHOPPING CENTER
DELIVERED
RERA NO: UPRERAPRJ46602



NOIDA INTERNATIONAL AIRPORT IN NEWS



Jai Shri Krishna



A 101 HECTARES (250 ACRES)
INTEGRATED TOWNSHIP
ON YAMUNA EXPRESSWAY

*is blessed with India's tallest statue of
Lord Shri Krishna standing majestically
at 108 feet height atop a grand Temple
(Under development)
Total Height - 135 feet*

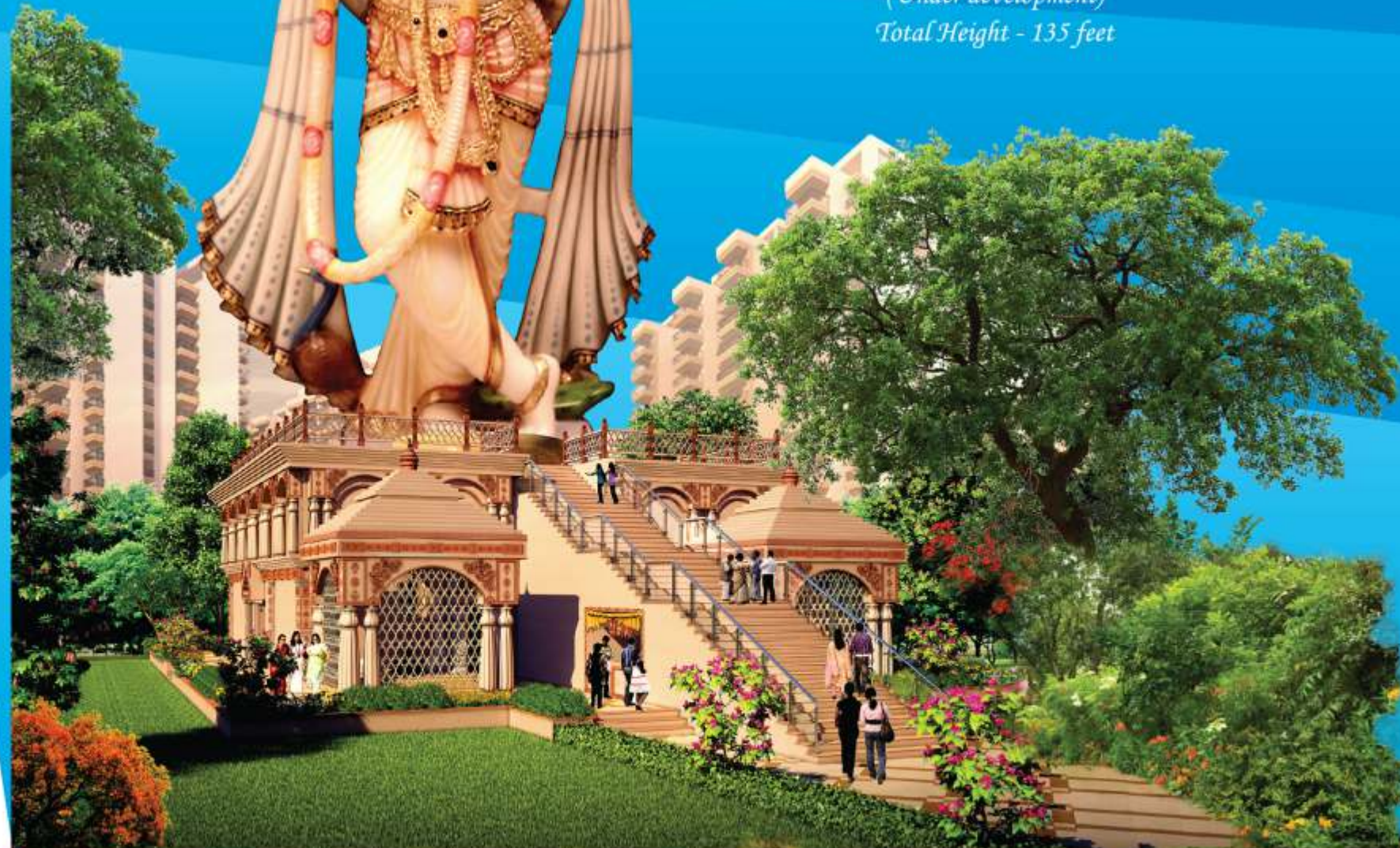

Disclaimer: All images including stock images, colours, pictures and accessories are indicative and used for illustrative purposes only. For the actual project details, please refer to the specifications mentioned in the subsequent pages of this brochure.



Disclaimer: All information above is in reference from newspapers and news portals.

HAPPY TO ANNOUNCE 3RD SCHOOL OPENING AT YAMUNA EXPRESSWAY

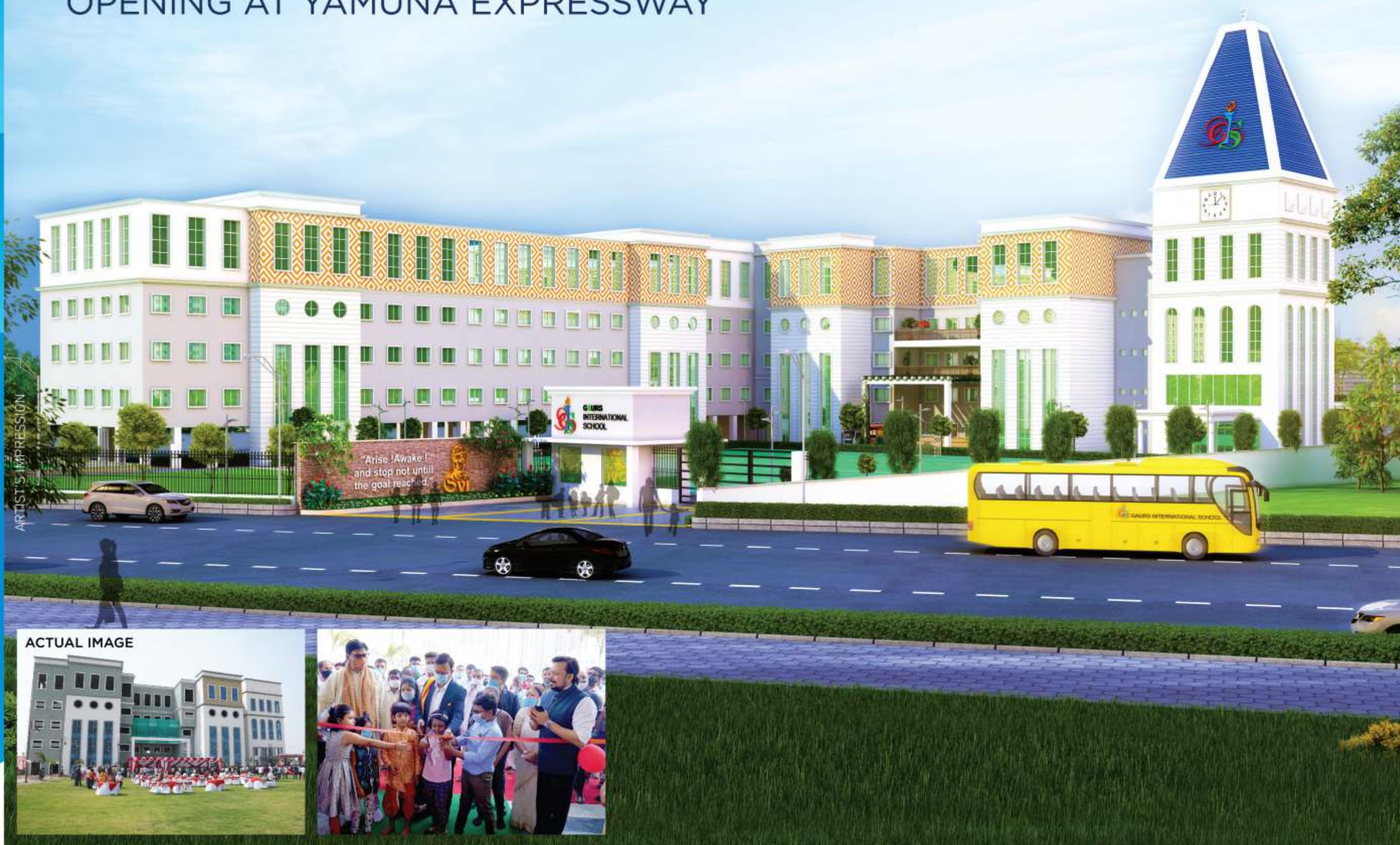

GAURS INTERNATIONAL SCHOOL

तमसो मा ज्योतिर्गमय ।

@

GAUR YAMUNA CITY, YAMUNA EXPRESSWAY

AFTER THE SUCCESS OF TWO BRANCHES OF GAURS INTERNATIONAL SCHOOL AT GAUR CITY WITH 3200+ STUDENTS, WE BRING THE PREMIER EDUCATIONAL INSTITUTE TO GAUR YAMUNA CITY. EQUIPPED WITH WORLD-CLASS FACILITIES AMIDST TOP NOTCH INFRASTRUCTURE AND AN INTERNATIONAL CURRICULUM, GAURS INTERNATIONAL SCHOOL BELIEVES IN NURTURING YOUR CHILD IN EVERY ASPECT.

HIGHLIGHTS

- AC CLASSROOMS
- BEST TEACHER STUDENT RATION
- SMART CLASSROOMS WITH PROJECTORS
- AMPHITHEATRE
- MUSIC, ART & DANCE ROOM
- MEDICAL ROOM
- RFID ENABLED ID CARDS
- CBSE BASED CURRICULUM
- CRICKET PITCH
- FOOTBALL
- VOLLEY BALL
- GPS ENABLED BUSES*

ADMISSIONS NOW OPEN FOR SESSION 2021-2022

NURSERY TO 5TH STANDARD

APPROVAL IN PROCESS FOR CLASS 6TH, 7TH & 8TH
www.gaurinternationalsschool.com



CNBC AWAAZ REAL ESTATE AWARDS 2018-19
BEST RESIDENTIAL PROJECT
AFFORDABLE SEGMENT - NORTH ZONE
- GAUR CITY-2



PMAY EMPOWERING INDIA AWARDS 2019
THE MOST WELL PLANNED UPCOMING
PROJECT IN EWS CATEGORY
- GAURS SIDDHARTHAM



TIMES BUSINESS AWARDS 2019
BEST REAL ESTATE
DEVELOPER OF THE YEAR
- GAURSONS INDIA



CNBC AWAAZ REAL ESTATE AWARDS 2017-18
BEST RESIDENTIAL PROJECT
AFFORDABLE SEGMENT - NATIONAL
- GAUR CASCADES



CNBC AWAAZ REAL ESTATE AWARDS 2017-18
BEST RESIDENTIAL PROJECT
AFFORDABLE SEGMENT - NORTH INDIA
- GAUR CASCADES



NDTV PROPERTY AWARDS 2016-17
BUDGET APARTMENT PROJECT
OF THE YEAR (2017) TIER 1 CITIES
- GAUR CASCADES



NDTV PROPERTY AWARDS 2016-17
BEST TOWNSHIP PROJECT
- GAUR CITY



CNBC AWAAZ REAL ESTATE AWARDS 2016-17
BEST TOWNSHIP PROJECT
- GAUR CITY



NDTV PROPERTY AWARDS 2015
BEST EXECUTION-TRACK RECORD
- GAUR CITY



SUCCESS FOUNDED ON TRUST

Ever since its inception in the year 1995, Gaurs has been revered as an icon of excellence in the world of real estate. With a burgeoning list of residential projects that encompass high end apartments to highly affordable accommodations occupied by thousands of happy families, Gaurs' stress on customer's trust has become the winning mantra. The pointed, unnerving focus on creating a better tomorrow has been the driving force at Gaurs. It is our foresight, eye for perfect locations and excellence in execution that has earned us a much-deserved success throughout our long journey. And armed with the confidence and verve to enrich lives, one can safely say that the future belongs to Gaurs.



ONGOING RERA REGISTERED PROJECTS

Gaur Mulberry Mansions, Gr. Noida (West)
UPRERAPRJ7057, UPRERAPRJ4897
KrishnVilas (3rd Parkview), Gaur Yamuna City
UPRERAPRJ16103
Gaur Saundaryam, Ph-2, Gr. Noida (West)
UPRERAPRJ6335
Gaurs Siddhartham, Siddharth Vihar
UPRERAPRJ3935
2nd Parkview, Gaur Yamuna City
UPRERAPRJ4464
Victorian Villas (6th Parkview), Gaur Yamuna City
UPRERAPRJ15838
16th Parkview, Gaur Yamuna City
UPRERAPRJ6801
32nd Parkview, Gaur Yamuna City
UPRERAPRJ4193
7th Avenue, Gaur City, Gr. Noida (West)
UPRERAPRJ6695
14th Avenue, Gaur City-2, Gr. Noida (West)
UPRERAPRJ6742
Gaur City Mall, Gr. Noida (West)
UPRERAPRJ6934
Gaur City Arcade, Gr. Noida (West)
UPRERAPRJ10206
GYC Galleria, Gaur Yamuna City
UPRERAPRJ4602
Gaurs Runway Suites, Gaur Yamuna City
UPRERAPRJ351477
Gaur City Center, Ph-II, Gr. Noida (West)
UPRERAPRJ4780
Gaurs Platinum Towers (Gaur Sportswood),
Sector-79, Noida UPRERAPRJ3528
7th Parkview, Gaur Yamuna City
UPRERAPRJ16087
Aerocity Yamuna, Gaur Yamuna City
UPRERAPRJ342117



GAURS INTERNATIONAL SCHOOL

Gaur City-2, Greater Noida (West)
Gaur Yamuna City, Yamuna Expressway
Gaurs Siddhartham, Siddharth Vihar



DELIVERED RETAIL PROJECTS

Gaur City Mall, Gaur Chowk, Greater Noida (W)
Gaur Central Mall, RDC, Raj Nagar, Ghaziabad



DELIVERED RESIDENTIAL PROJECTS

Gaur Residency, Chander Nagar
Gaur Galaxy, Vaishali
Gaur Heights, Vaishali
Gaur Ganga, Vaishali
Gaur Ganga 1, Vaishali
Gaur Ganga 2, Vaishali
Gaur Green City, Indirapuram
Gaur Green Avenue, Indirapuram
Gaur Green Vista, Indirapuram
Gaur Valerio, Indirapuram
Gaur Homes, Govindpuram
Gaur Homes Elegante, Govindpuram
Gaur Grandeur, Noida
Gaur Global Village, Crossings Republik
Gaur Gracious, Moradabad
Gaur Cascades, Raj Nagar Extn. Ghaziabad
Gaur Saundaryam, Ph-1, Gr. Noida (West)
1st Avenue, Gaur City
4th Avenue, Gaur City
5th Avenue, Gaur City
6th Avenue, Gaur City
10th Avenue, Gaur City-2
11th Avenue, Gaur City-2
12th Avenue, Gaur City-2
14th Avenue, Ph-1, Gaur City-2
16th Avenue, Gaur City-2
Gaur Sportswood, Sector-79, Noida
Gaur Atulyam, Gr. Noida
2nd Parkview, Yamuna Expressway
16th Parkview, Ph-1, Gaur Yamuna City
32nd Parkview, Gaur Yamuna City



DELIVERED COMMERCIAL PROJECTS

Gaur High Street (Rajnagar Extn.), Ghaziabad
Gaur Gravity, Ghaziabad
Gaur Square, Govindpuram, Ghaziabad
Gaur City Plaza-Gaur City, Gr. Noida (West)
Gaur Biz Park, Indirapuram
Gaur City Galleria, Gr. Noida (West)
GYC Galleria, Gaur Yamuna City
Gaur City Center, Ph-I, Gr. Noida (W)

25+
YEARS OF UNFLINCHING
COMMITMENT

50+
SUCCESSFULLY
DELIVERED PROJECTS

20000+
UNITS
UNDER DEVELOPMENT

30000+
POSSESSIONS
GIVEN (2014-2019)

50000+
DELIVERED
UNITS

100000+
HAPPY
CUSTOMERS

5500000+
SQUARE METER
AREA DEVELOPED

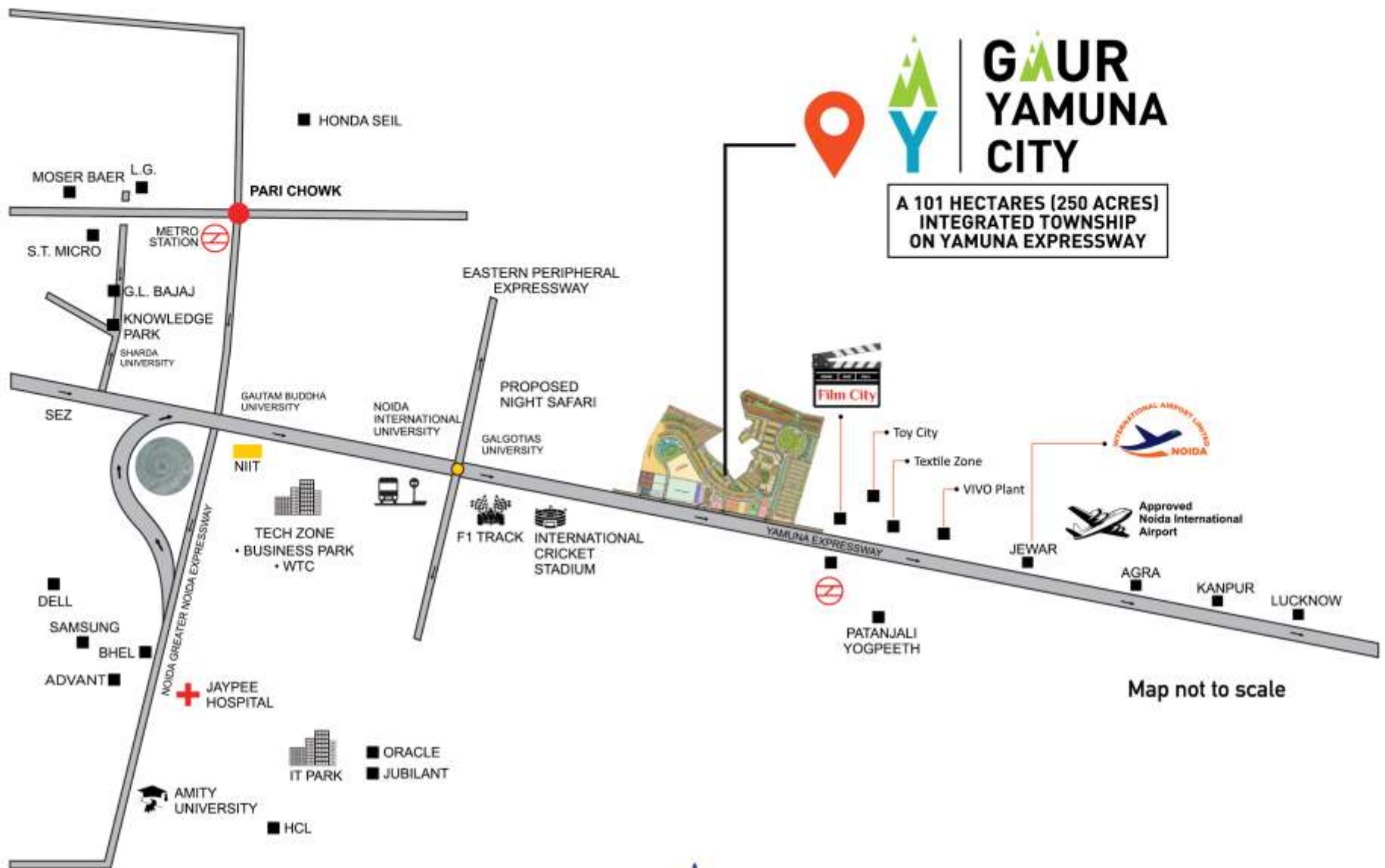

RESIDENTIAL PLOTS @ GAUR YAMUNA CITY

SITE OFFICE: SEC-19, YAMUNA EXPRESSWAY, DIST. GAUTAM BUDDH NAGAR (U.P.)
 CORPORATE OFFICE: GAUR BIZ PARK, PLOT NO-1, ABHAY KHAND II, INDIRAPURAM GHAZIABAD - 201014
 RERA REGN. NO: UPRERAPRJ16087 | www.up-rera.in

www.gaursonsindia.com



www.gaursonsindia.com



Payment Gateway for existing customers



www.facebook.com/GaursonsIndia



www.twitter.com/gaursons_india

AFTER SALES CUSTOMER CARE 1800 180 3052

REAL ESTATE | RETAIL | EDUCATION | HOTELS | SPORTS | INFRASTRUCTURE | MEDIA