



ARTISTIC IMAGE

UNDER HARYANA AFFORDABLE HOUSING POLICY

COST SHEET

Category (Type)	No of Units	Carpet Area sqft(approx)	Balcony Area sqft(approx)	Allotment Rate of Apartment (all inclusive)*	With Application Booking amount 5%	On Allotment 20%
2BHK TYPE -01	82	585.551	83.701	23,84,055	1,19,203	4,76,811
2BHK TYPE -02	30	594.065	82.151	24,17,336	1,20,867	4,83,467
2BHK TYPE -03	99	594.829	74.401	24,16,517	1,20,826	4,83,303
2BHK TYPE -04	21	592.860	85.703	24,14,292	1,20,715	4,82,858
2BHK TYPE -05	34	586.573	83.055	23,87,820	1,19,391	4,77,564
2BHK TYPE -07	3	548.889	99.589	22,45,351	1,12,268	4,49,070

PAYMENT TERMS: (I) WITH APPLICATION: BOOKING AMOUNT, I.E., 5% OF COST OF FLAT (II) 20% OF COST OF FLAT ON ALLOTMENT (III) BALANCE 75% OF THE AMOUNT IN SIX EQUATED 6 MONTHLY INSTALLMENT SPANNING OVER A PERIOD OF THREE YEARS. HOWEVER, THE MAXIMUM AMOUNT RECOVERABLE AT THE TIME OF ALLOTMENT SHALL BE EQUIVALENT TO THE AMOUNT PAYABLE BY OTHER ALLOTTEES OF 1ST DRAW IN THE PROJECT AT THAT STAGE AS PER AMENDMENT NOTIFICATION NO. PF-27/15922 05, JULY, 2019. NO INTEREST SHALL FALL DUE BEFORE THE DUE DATE OF PAYMENT. ANY DEFAULT IN PAYMENT WILL BEAR PENAL INTEREST AS PROVIDED IN RULE 15 OF THE HARYANA REAL ESTATE REGULATORY AUTHORITY, RULES, 2017.



AN ISO 9001:2015; 14001:2015; 45001:2018 CERTIFIED COMPANY

SIGNATURE INFRABUILD PRIVATE LIMITED | CIN : U70100DL2013PTC247676

Regd. Office: Unit No. 1310 At 13th Floor Dr. Gopal Das Bhawan, 28 Barakhamba Road New Delhi 110001

Corp. Office: Ground Floor, Tower A, Signature Tower, South City -1, Gurugram, Haryana-122001 | www.signatureglobal.in

HOME LOAN PARTNERS:



AVAIL INTEREST SUBSIDY BENEFITS OF RS. 2.67 LACS (APPROX) UNDER PMAY (PRADHAN MANTRI AWAAS YOJANA)**

Promoter urges every applicant to inspect the project site and shall not merely rely upon or to be influenced by any architectural impression, plan or sales brochure and therefore, requested to make personal judgment prior to submitting an application for allotment. The images shown here are indicative of design and for illustration purposes only. Further, the actual design may vary in fit and finished from the one displayed above. Project details / specifications can also be accessed at the office of Haryana Real Estate Regulatory Authority website <https://haryanarera.gov.in/>. Journey time shown, if any, is based upon google maps which may vary as per traffic at relevant point of time. *Rate mentioned above does not include GST and other statutory charges, if applicable, T & C Apply. 1 Sq. mt = 10.7639 sq. ft. **The subsidy differs as per the eligibility of the client's profile and the loan amount. This is the max amount of subsidy that a client can receive and the same goes with the loan amount too for availing the subsidy. Please note that the loan can be sanctioned more than 12 lacs but subsidy can be availed only till 12 lacs of loan amount. Rate mentioned above does not include GST and other statutory charges if applicable, T & C Apply. 1 Sq. mt = 10.7639 sq. ft.

HRERA REG. NO.: 69 OF 2019 DATED 14.11.2019

LICENSE NO.: 73 OF 2019 AND 04.07.2019

FOR ANY QUERY PLEASE SPEAK TO OUR CUSTOMER RELATIONSHIP MANAGER



ARTISTIC IMAGE



DESIGNED BY PADMABHUSHAN ARCHITECT HAFEEZ CONTRACTOR



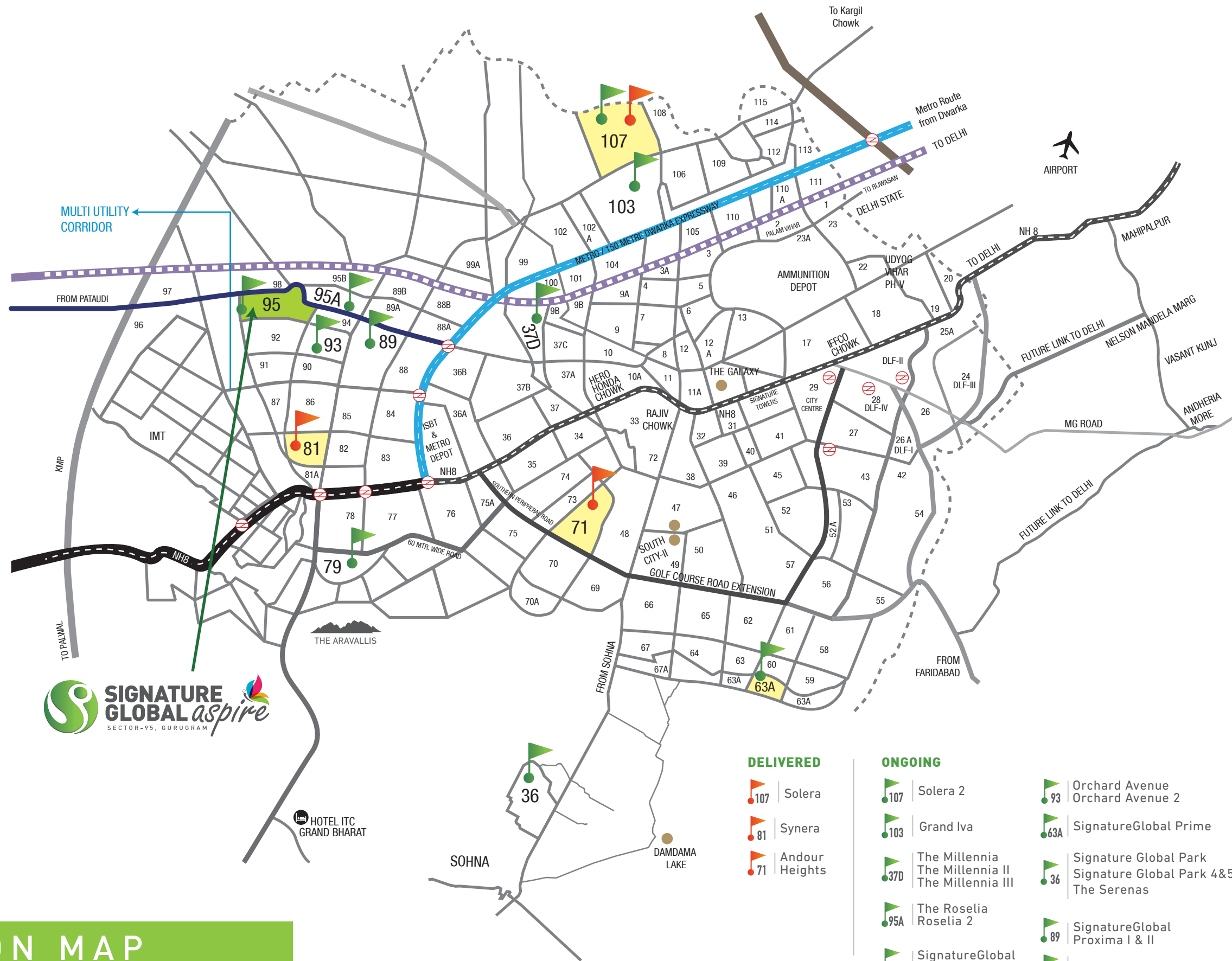

LOCATION MAP

MAP SHOWN HERE IS BASED UPON THE GOOGLE MAPS

DELIVERED

- 107 Solera
- 81 Synera
- 71 Andour Heights

ONGOING

- 107 Solera 2
- 103 Grand Iva
- 37D The Millennia I
The Millennia II
The Millennia III
- 95A The Roselia
Roselia 2
- 95 SignatureGlobal Aspire
SignatureGlobal Superbia
- 93 Orchard Avenue
Orchard Avenue 2
- 63A SignatureGlobal Prime
- 36 Signature Global Park
Signature Global Park 4&5
The Serenas
- 89 SignatureGlobal Proxima I & II
- 79 Golf Greens 79

SITE PLAN

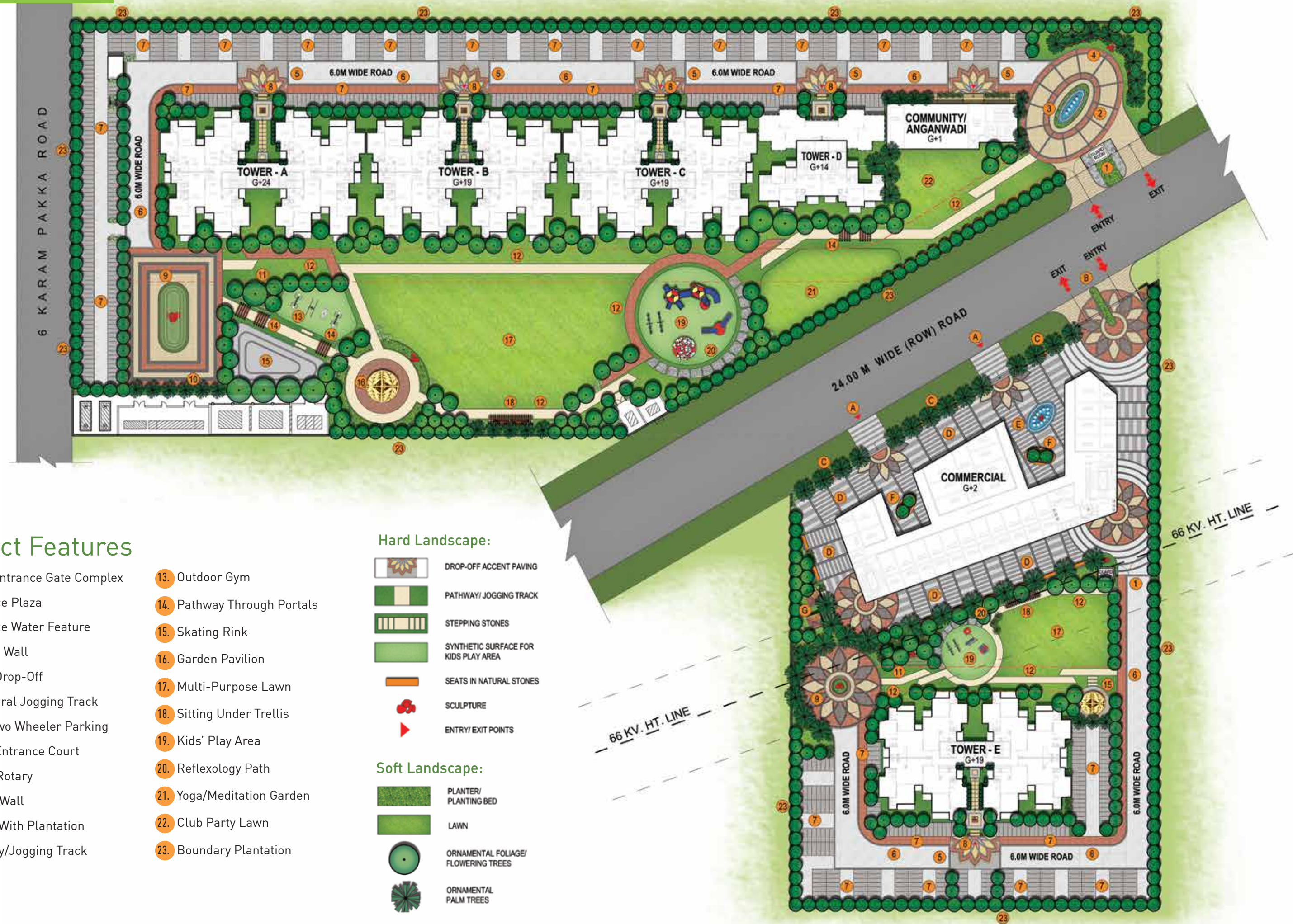

Project Features

- | | |
|--------------------------------|-----------------------------|
| 1. Entry/Entrance Gate Complex | 13. Outdoor Gym |
| 2. Entrance Plaza | 14. Pathway Through Portals |
| 3. Entrance Water Feature | 15. Skating Rink |
| 4. Feature Wall | 16. Garden Pavilion |
| 5. Tower Drop-Off | 17. Multi-Purpose Lawn |
| 6. Peripheral Jogging Track | 18. Sitting Under Trellis |
| 7. Open Two Wheeler Parking | 19. Kids' Play Area |
| 8. Tower Entrance Court | 20. Reflexology Path |
| 9. Traffic Rotary | 21. Yoga/Meditation Garden |
| 10. Screen Wall | 22. Club Party Lawn |
| 11. Mound With Plantation | 23. Boundary Plantation |
| 12. Pathway/Jogging Track | |

Hard Landscape:

- | | |
|--|--------------------------------------|
| | DROP-OFF ACCENT PAVING |
| | PATHWAY/ JOGGING TRACK |
| | STEPPING STONES |
| | SYNTHETIC SURFACE FOR KIDS PLAY AREA |
| | SEATS IN NATURAL STONES |
| | SCULPTURE |
| | ENTRY/ EXIT POINTS |

Soft Landscape:

- | | |
|--|-------------------------------------|
| | PLANTER/ PLANTING BED |
| | LAWN |
| | ORNAMENTAL FOLIAGE/ FLOWERING TREES |
| | ORNAMENTAL PALM TREES |



C. A - 585.551 SQ.FT. | B. A - 83.701 SQ.FT.

TYPE 1 (2BHK) | Cost @ ₹23,84,055

C. A - CARPET AREA | B. A - BALCONY AREA



C. A - 594.065 SQ.FT. | B. A - 82.151 SQ.FT.

TYPE 2 (2BHK) | Cost @ ₹24,17,336

C. A - CARPET AREA | B. A - BALCONY AREA



C. A - 594.829 SQ.FT. | B. A - 74.401 SQ.FT.

TYPE 3 (2BHK) | Cost @ ₹24,16,517

C. A - CARPET AREA | B. A - BALCONY AREA



C. A - 592.860 SQ.FT. | B. A - 85.703 SQ.FT.

TYPE 4 (2BHK) | Cost @ ₹24,14,292

C. A - CARPET AREA | B. A - BALCONY AREA



SKATING RINK

ARTISTIC IMAGE



PATHWAY THROUGH PORTALS

ARTISTIC IMAGE



KIDS' PLAY AREA

ARTISTIC IMAGE